

TYPICAL OVERALL RUNWAY 15/33, LAYOUT KLIA2

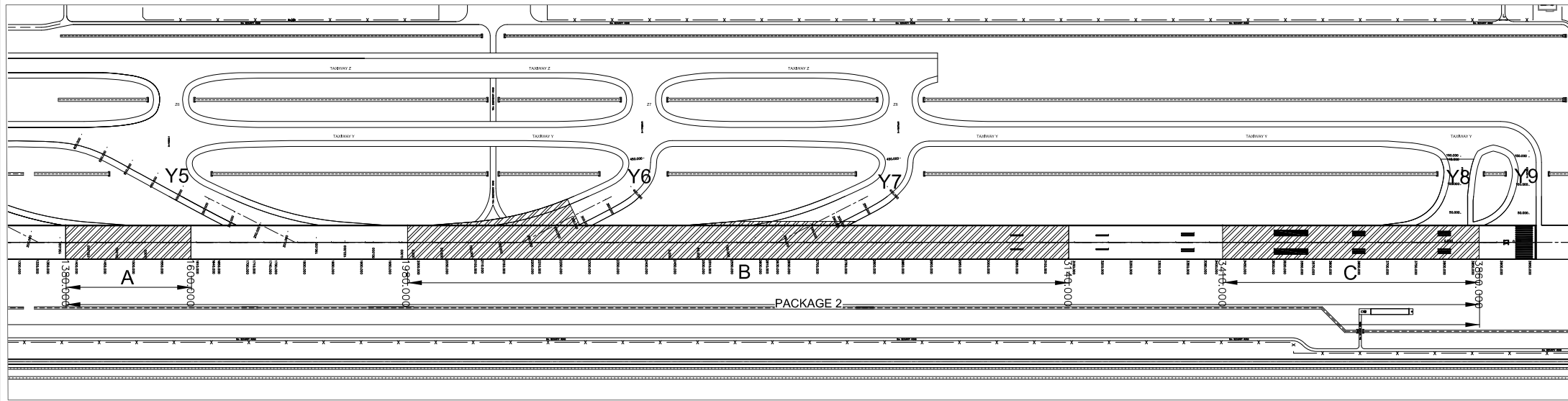

PACKAGE 2 WORKS

NOTE

- 1.0 COMMENCES FROM 1400 UTC, 29 FEBRUARY 2020 TO 0200 UTC, 30 APRIL 2020.
- 1.1 RUNWAY 15/33 CLOSED 12 HOURS FROM 1400 UTC TO 0200 UTC. (MONDAY TO SATURDAY).
- 2.0 1400 UTC, 30 APRIL 2020 TO 2200 UTC, 15 JULY 2020.
- 2.1 RUNWAY 15/33 CLOSED 8 HOURS FROM 1400 UTC TO 2200 UTC. (MONDAY TO SATURDAY).
- 3.0 RUNWAY CENTERLINE LIGHTS WILL BE DEENERGISED.

LEGEND



= CONSTRUCTION AREA SECTION A, B & C



= TRIANGULAR MARKERS