AIP SUPPLEMENT MALAYSIA

PHONE : 6-03-8871 4000
TELEX : PENAWA MA 30128
FAX : 6-03-8881 0530
AFTN : WMKKYAYS
COMM : AIRCIVIL
KUALA LUMPUR

AERONAUTICAL INFORMATION SERVICES
DEPARTMENT OF CIVIL AVIATION
NO. 27, PERSIARAN PERDANA
LEVEL 1-4, PODIUM BLOCK, PRECINCT 4,
62618 PUTRAJAYA
MALAYSIA

01 / 2009
07 JAN

KUALA LUMPUR FLIGHT INFORMATION REGION KL INTERNATIONAL AIRPORT

NEW ADDITIONAL AIRCRAFT PARKING STANDS AND MODIFICATION TO EXISTING PARKING CONFIGURATION AT THE EXISTING LOW COST CARRIER TERMINAL APRON

1. INTRODUCTION

- 1.1 The purpose of this AIP Supplement is to notify the aviation industry of the introduction of new aircraft parking stands and the modification of existing parking stands at the existing Low Cost Carrier Terminal (LCCT) Apron.
- 1.2 The information provided in this AIP Supplement is presented in similar ICAO format as applicable for the AIP Malaysia.

2. MOVEMENT AREAS

2.1 New Parking Stands

- 2.1.1 The new parking stands are located at the South East section of the LCCT Apron.
- 2.1.2 A new parking cul-de-sac to accommodate six (6) parking stands for aircraft type A320/B737, in Power In Push Back configuration (F101 to F106) or two (2) parking stands for aircraft type A320/B737 in Power In Power Out(PIPO) configuration (F107 &F108).Refer to Appendix A.

2.2 Modification of existing parking stands

- 2.2.1 Existing parking stands at the NW section of the LCCT apron will be modified.
- 2.2.2 Parking stands F51,F53, F55 and F57 will cease to be operational.
- 2.2.3 The parking stand F24 is for Aircraft type B747 and parking stands F24L and F24R are for aircraft type A320/B737 in Power In Push Back configuration. Refer to Appendix A.
- 2.2.4 F52, F54, F56 for aircraft type A320/B737 in Power In Push Back configuration and F58 is for Power In Power Out.

2.2.5 F25 will be introduced for aircraft type B747 in Power In Push Back configuration. Please refer to Appendix A.

2.2.6 The New Aircraft Parking stand Positions are indicated in Appendix B.

3. IMPLEMENTATION

3.1 This AIP Supplement and relevant charts will be applicable with immediate effect for Parking stands F101 to F108 while parking stands F24, F24L/R and F25 will be applicable on 20 February 2009 at 0001UTC.

4. CANCELLATION

4.1 This AIP Supplement will remain current until the information is published in AIP Malaysia.

DATO' AZHARUDDIN ABDUL RAHMAN
Director General
Department of Civil Aviation
Malaysia

AIRCRAFT PARKING/DOCKING CHART-ICAO
 AIRCRAFT STAND CONFIGURATION AT LCC TERMINAL, KLIA, SEPANG, MALAYSIA

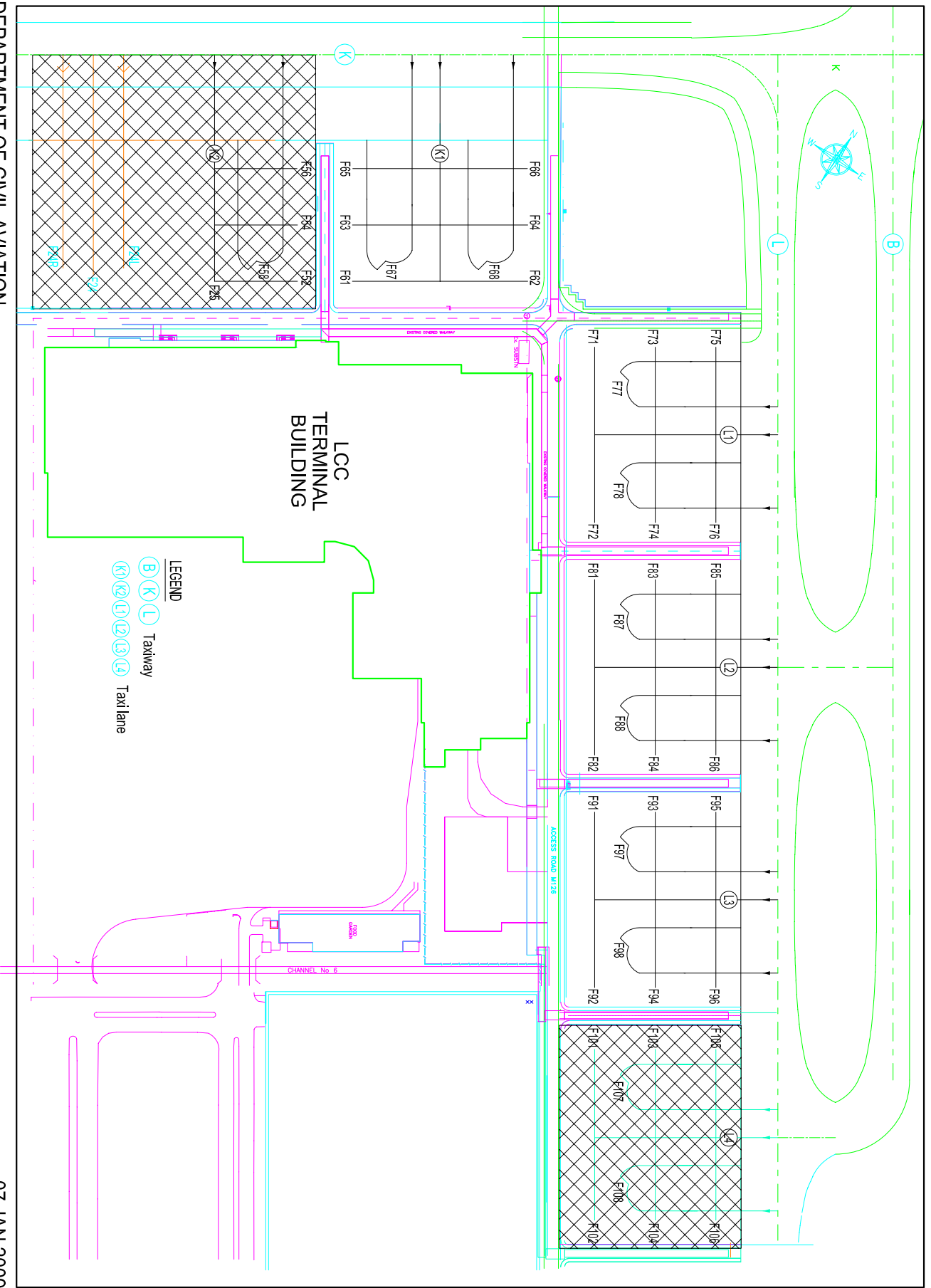

AIRCRAFT PARKING AND DOCKING - STAND POSITION

| TERMINAL | APRON | AIRCRAFT STAND | | AIRCRAFT TYPE | COORDINATES (WGS84) | |
|----------|--|--------------------|--------------------|---------------|---------------------|---------------|
| | | Power In Push Back | Power In Power Out | | LAT (N) | LONG (E) |
| LCC | NORTH (CN) Lumpur Ground 123.25MHz | F24 | | B747 | 2°44'26.69" | 101°43'02.41" |
| | | F24R | | B737/A320 | 2°44'26.42" | 101°43'01.76" |
| | | F24L | | B737/A320 | 2°44'27.19" | 101°43'02.90" |
| | | F25 | | B747 | 2°44'28.17" | 101°43'04.61" |
| | EAST (CE) Lumpur Ground 123.25MHz | F101 | | B737/A320 | 2°44'18.52" | 101°43'21.62" |
| | | F102 | | B737/A320 | 2°44'15.09" | 101°43'23.92" |
| | | F103 | | B737/A320 | 2°44'19.29" | 101°43'22.76" |
| | | F104 | | B737/A320 | 2°44'15.86" | 101°43'25.06" |
| | | F105 | | B737/A320 | 2°44'20.07" | 101°43'23.90" |
| | | F106 | | B737/A320 | 2°44'16.64" | 101°43'26.20" |
| | | | F107 | B737/A320 | 2°44'18.32" | 101°43'22.68" |
| | | | F108 | B737/A320 | 2°44'16.30" | 101°43'24.04" |